

Sidewalk Closure (Pedestrian Detour)

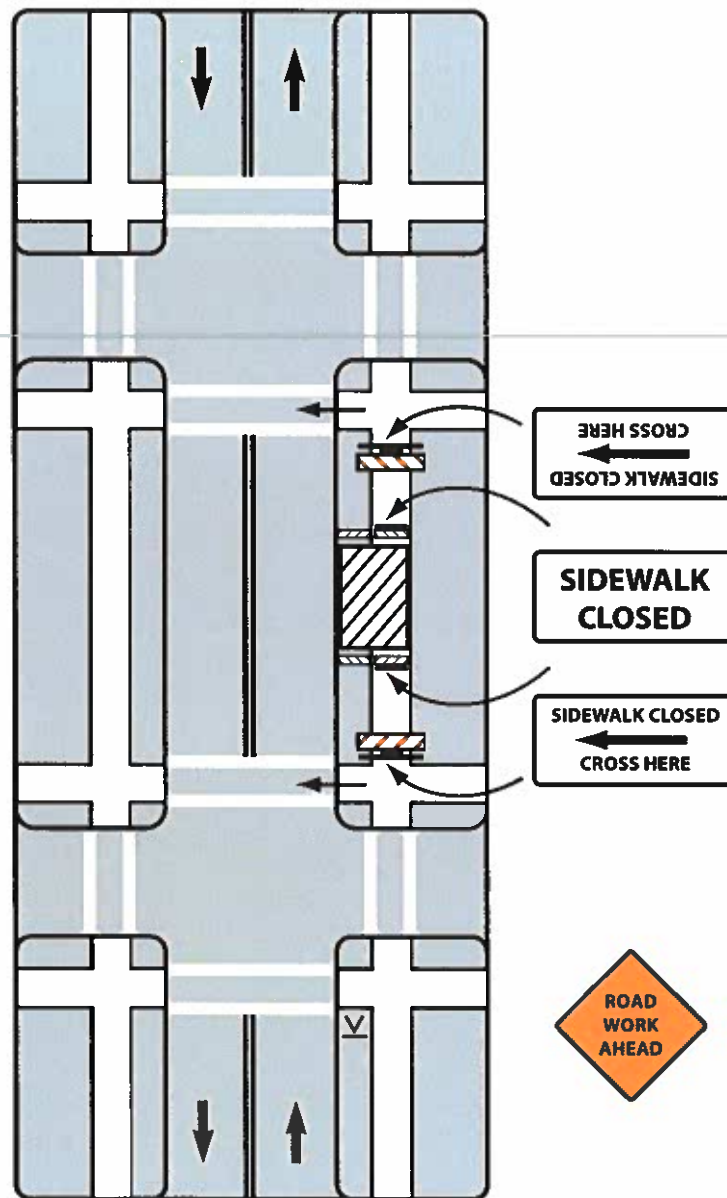

Notes:

1. Where sidewalks exist, make provisions for persons with disabilities.
2. Only the traffic control devices controlling pedestrian flows are shown. Other devices may be needed to control traffic on the streets. Use lane closure signing as needed.
3. For nighttime closures, Type A flashing warning lights may be used on barricades that close walkways. Temporary street lighting may also be considered.